

Penguins!

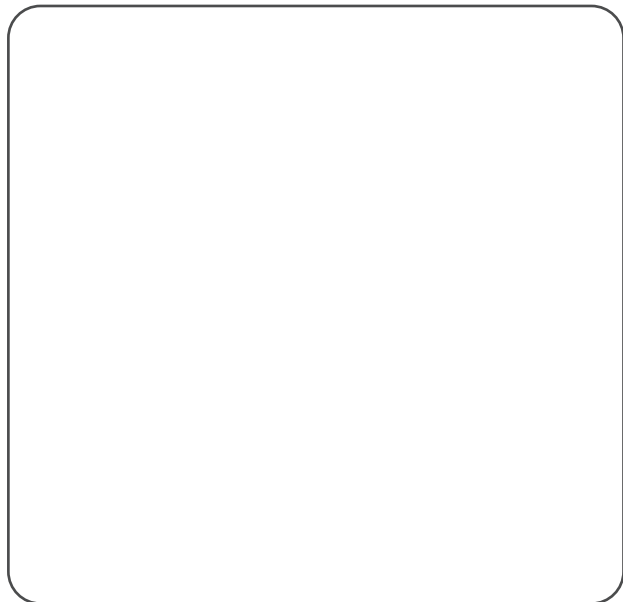

You can
Draw a penguin!

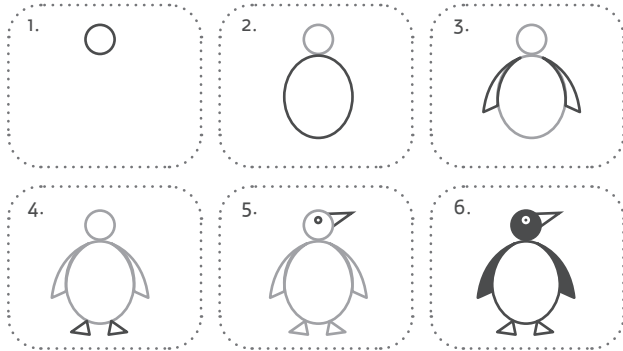

Maze

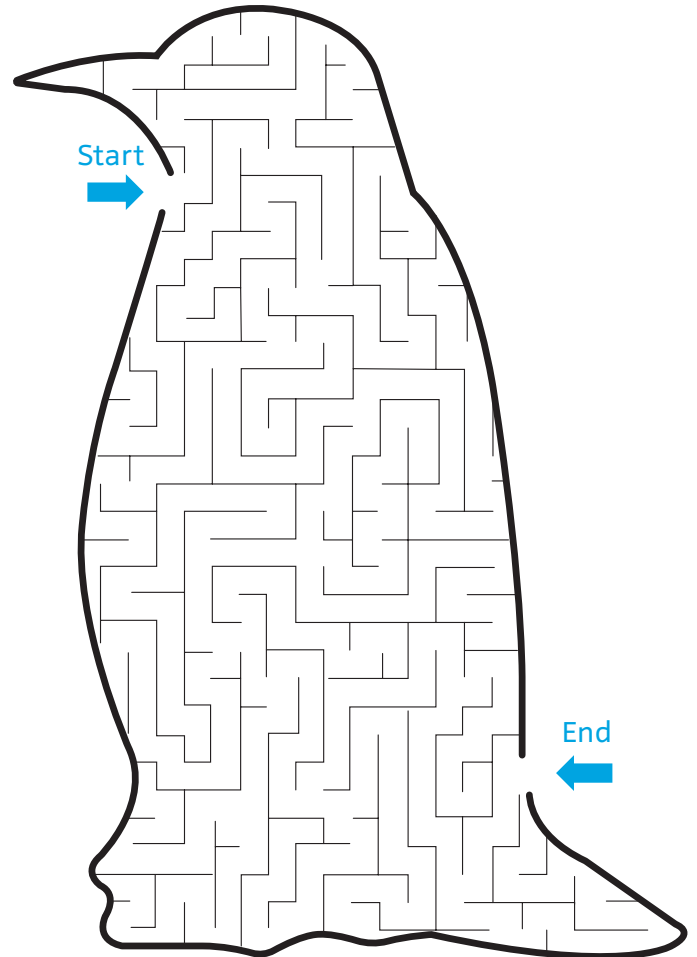

Seahorse
Word Search

S W I M U X L R Q L W H N S I
 C A J F L A J H E B W S I L Y
 C I T C R A T N A H D I U I S
 D F O K A E B T I E T F G D U
 I K O L E E E B W E I K E F I
 B L A C K A E O S X J N P F C
 D Q O J F W N N V Y T F G X E
 Q H B E O S M W X I O T C F V
 Q U L N N K Z Y K P H S F A O

Find 15 Hidden words:

ANTARCTIC	PENGUIN
BEAK	SLIDE
BLACK	SNOW
COLD	SWIM
FEATHER	WEBBED
FISH	WHITE
ICE	WING
OCEAN	

Penguins!



King penguin parents incubate their egg by balancing it on their feet for 55 days. They do not swim or eat during this time!



Did you know

That King penguin chicks used to be thought of as a different species as they look so different to the adults? They used to be known as Woolly penguins!

Did you know

That male and female penguins look the same? The female is usually slightly smaller. Penguins tell each other apart by their unique song.

Did you know

that King penguin chicks can hear their parents from inside their egg? When they hatch they recognise their parent by the noise they make!

Penguins!



Join the
Dots!

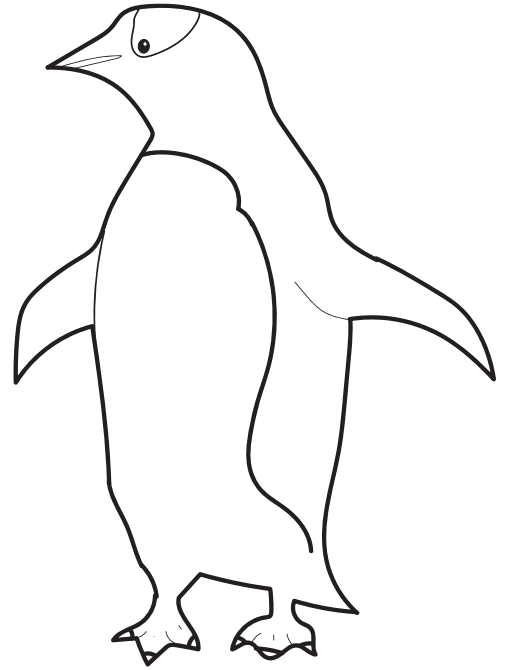
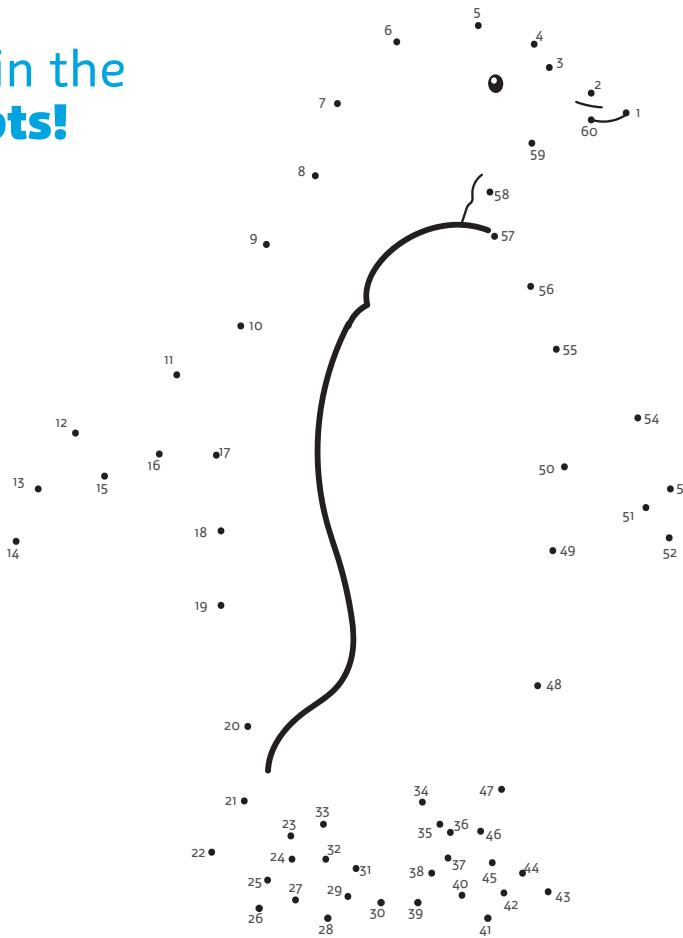

Did you know
that in the past large penguin colonies were discovered by following the tracks of penguin footprints in the snow?

