



TWO AMAZING ATTRACTIONS UNDER ONE ROOF!

The more you see, the more you save! Double the fun with a visit to LEGOLAND Discovery Center and SEA LIFE Aquarium Kansas City! Enjoy rides, learn to build like a LEGO expert, and more when you visit LEGOLAND Discovery Center and Discover the world underwater at SEA LIFE Aquarium! Enjoy just one attraction or both with the Combo Ticket! Both attractions are conveniently located next to each other in the Crown Center District!

Group Preparation Guide

Group Requirements & Benefits:

- ✓ Discounted group rates are available for advance group bookings of 10 or more
- ✓ Advanced pre-paid reservations are required a minimum of 7 days prior to the visit date
- ✓ One adult chaperone must accompany every 10 children (Grades K-12).
- ✓ School Groups: Receive one free adult ticket with every 5 student tickets purchased. Comp tickets will automatically be added to the cart during the checkout process.
- ✓ Groups: Receive one free adult ticket with every 10 child tickets purchased. Comp tickets will automatically be added to the cart during the checkout process.
- ✓ Tax Exempt rates are available. Please email your **Missouri** tax exempt form and booking confirmation number to (KC.Groups@merlinentertainments.biz) after your purchase. Be sure to click on the tax-exempt booking link. Tax will not be added to your order. If tax is showing up in your cart at check out, go back to the main website and find the tax-exempt booking link.

Visit Duration:

- ✓ The tour through each attraction is self-guided. It should take you approximately 60 to 90 minutes to complete each attraction. Groups visiting both attractions can plan to be on-site for up to 3 hours. However, you may take as little or as long as you need to experience the entire attraction. Ability to re-enter the attractions will depend on the volume of guests during the time of your visit.

Booking Process:

- ✓ All reservations must be made online through the secure Online Booking Portal
- ✓ <https://www.visitsealife.com/kansas-city/schools-groups/>
- ✓ <https://www.legolanddiscoverycenter.com/kansas-city/groups-schools/>
- ✓ Group tickets are timed & dated
- ✓ Select your arrival day & time to enter the attractions when purchasing tickets. For Combination tickets to attractions, **the time and date you select for your visit is the entry time for LEGOLAND Discovery Center** and your visit to SEA LIFE Aquarium can be done either before or after that visit on the same day.
- ✓ Receive an instant email confirmation of your digital tickets. No need to print physical tickets.
- ✓ Tax Exempt rates are available. Please email your tax-exempt form and booking confirmation number to (KC.Groups@merlinentertainments.biz) after your purchase.

Payment:

- ✓ Payments must be made with a credit/debit card at the time of booking. **We do not have invoicing available.** If your organization does not have the ability to pay with debit or credit, please email KC.Groups@merlinentertainments.biz to inquire about check payments.
- ✓ Payment types accepted: Visa, MasterCard, American Express, and Discover. Our attractions are completely CASH FREE therefore we do not accept any cash payment.
- ✓ Additional tickets cannot be added to your original reservation after your order is made, but more tickets can be added upon your arrival at the discounted group rate if capacity allows. If you have additional adults who wish to purchase their own discounted tickets upon arrival, please let us know if advance by emailing KC.Groups@merlinentertainments.biz.
- ✓ If you end up having fewer individuals than originally booked, you can contact the Group Sales Department at (KC.Groups@merlinentertainments.biz) in advance for a partial refund, or let your Admissions Host know upon arrival the total number of guests attending with your group so unused tickets may be refunded. (Refunds are not always guaranteed. Complimentary tickets for the number of guests that did not visit may be given instead. These will have one year validity from the original visit date.)
- ✓ If cash is the only payment you have, you can obtain our total for your purchase from a host and then go to Crown Center Customer Service across the street (2nd floor next to the Chocolate Factory). They can add your funds to a Crown Center Gift Card that can be used on our payment devices at the registers.

Cancellation, Reschedule and No Show Policy:

- ✓ Paid reservation may be cancelled or rescheduled any time prior to 48 hours of your original visit date by emailing (KC.Groups@merlinentertainments.biz).
- ✓ Tickets expire on the date and time they are purchased for.
- ✓ There are NO REFUNDS on unused tickets after your visit date has passed.

Location:

- ✓ Both attractions are located on 2475 Grand Blvd in the Crown Center District. For guests staying on Grand Blvd, both attractions are easily accessible by walking. Crown Center Shopping Center is located across the street. Union Station, which house the last stop for the KC street car is 0.5 miles from the attraction. The street car can take guests farther into northern downtown Kansas City.
- ✓ 2475 Grand Blvd, Kansas City, MO, 64108

Recommendations & Important Information:

- ✓ Please have your group pre-sorted into groups of no more than 10 students to ensure a more bricktastic and fintastic visit and to minimize wait times for those attractions that have a guest limit.
- ✓ Children should not bring more than their coats, hats, gloves, etc. There is no storage facility and we are not responsible for any lost or stolen items. Please refer to information about Crown Center's Lunchland at the end of this guide.
- ✓ We do not allow outside food into the center; please plan all meals before or after your visit.
- ✓ We recommend socks and closed-toe shoes for all children so they can partake in all activities.
- ✓ All rides inside LEGOLAND Discovery Center have separate ride restrictions and some children may not be able to ride if they do not meet these requirements.
- ✓ Please visit the website for individual attraction information and requirements <https://www.legolanddiscoverycenter.com/kansas-city/whats-inside/attractions-overview/>
- ✓ All rides may require a chaperone to ride with each child or group of children

- ✓ Building & playing areas require chaperone supervision at all times.
- ✓ All the attractions inside LEGOLAND® Discovery Center are included in the price of the admission except the VR Experience, photo, and the Coffee Shop. No cash payments can be accepted for these additional experiences.
- ✓ All exhibits inside SEA LIFE Aquarium are included in the price of admissions except photo.
- ✓ Guests can bring additional money (CREDIT OR DEBIT CARD ONLY AS WE ARE A COMPLETELY CASH FREE SITE) to purchase food from our Coffee Shop, VR Experience, Souvenir photos or LEGO®/SEA LIFE products from our gift shop.

Arriving at the Attraction:

Crown Center Parking Garage

- ✓ Guests can park in Crown Center's Parking Garage
- ✓ Please visit Crown Centers Website for information: <https://www.crowncenter.com/visitor-information/parking>
- ✓ When guests visit our attractions we do validate for 6 hours of parking during the week. You will need to ask for this validation in admissions upon arrival.

Oversized Vehicle/Motor Coach/Bus Drop Off & Parking

- ✓ Buses can drop groups off using the retail pull-off located on Grand Blvd (east side).
- ✓ Bus Parking is FREE – Located along Warwick Trafficway between 26th and 27th Streets, as well as along McGee Street Trafficway (North of 26th Street).
- ✓ For vehicles taller than 6.5' you will not fit in the garage therefore you will need to find alternative parking or park in the bus parking area
- ✓ Please visit <https://www.crowncenter.com/sites/default/files/inline-files/Bus%20Parking%20-%20Retail%2010202016.pdf> to view the Bus/Oversized Vehicle Parking map.

Entering the Attraction

- ✓ Groups should remain pre-sorted into small groups outside of the admissions doors along the glass dividing walls prior to entrance.
- ✓ Only the group leader should enter the queue line to check in the group for the day.
- ✓ Present your group order confirmation to the attractions front desk. Groups with combo tickets should arrive at the LEGOLAND Discovery Center admission counter to check in.
- ✓ We ask for your assistance in keeping your group together at this time as our staff will deliver the attraction's rules and provide further instruction before entering.

Amenities:

- ✓ Gift Shop
- ✓ Restroom / changing tables & Family Restrooms
- ✓ Photo Op Areas (just before entering attractions after admissions desk and for LEGOLAND after the Kingdom Quest ride). These photos are not included in the price of admission.
- ✓ Lockers (Inside LEGOLAND Only)
- ✓ Coffee Shop (Inside LEGOLAND Only)

Accessibility:

- ✓ **How do both attractions accommodate Guests with disabilities?** Our facilities are designed to be fully accessible to guests with a disability. Our trained staff will ensure that guests who need assistance are transported safely by an elevator designated for this purpose.
- ✓ **Can I use my own wheelchair inside the attractions?** Yes. You may use your own wheelchair at LEGOLAND Discovery Center and SEA LIFE Aquarium.
- ✓ **Do you have wheelchairs to rent?** We do not have wheelchairs, scooters, or strollers to rent at our attractions. Crown Center does have wheelchairs and strollers available to rent. Please feel free to give Crown Center Customer Service a call for more information **(816)-274-7251**.

- ✓ **Can I bring my Service Animal to either attraction?** Service Animals are welcomed inside the attraction. At LEGOLAND Discovery Center & SEA LIFE Aquarium, a service animal is a dog or miniature horse that is trained to do work or perform tasks for, and to assist, an individual with a disability. Service animals must be under the control of the owner at all times and should remain on a leash or in a harness. Employees are not able to take control of service animals. Emotional Support animals are not considered service animals and therefore will not be allowed entry. Service animals are not allowed on any of our rides inside LEGOLAND Discovery Center.

Additional FAQs:

- ✓ **Can I take a camera/phone to the attractions?** We encourage taking many photos! For our creature's safety inside SEA LIFE Aquarium, we do ask that guests turn off their flash to their cameras and cellphones. Cameras are permitted in all public areas of the attractions except while on any rides. If you are a film crew or press and need access to the attraction, please contact our Marketing team for further information.
- ✓ **No outside food or beverage is allowed inside either attraction**
- ✓ **Storage:** Kindly make your own personal arrangements to store large bags and luggage prior to your visit.
- ✓ **Weapons:** Help make our attractions a safe place for fellow patrons and staff by leaving weapons of any kind at home. Signage is posted on the outside of our doors before entering and guests will be asked to leave if a weapon is found on them.
- ✓ For the most recent updates to our FAQs, please check <https://www.legolanddiscoverycenter.com/kansas-city/plan-your-day/information/faqs/#how-do-we-ensure-school-and-group-safety-as-well-as-well-being-in-our-attraction> or <https://www.visitsealife.com/kansas-city/plan-your-day/information/faq/>

Nearby Restaurants / Areas To Eat Bagged Lunches:

NEARBY RESTAURANTS

- ✓ Panera Bread
- ✓ Starbucks
- ✓ Burnt End BBQ
- ✓ Taste of Philly, Greek Food & Potatoes and More
- ✓ Pak Ling Express
- ✓ Unforked
- ✓ Curry in a Hurry
- ✓ Spin Pizza
- ✓ Sheridan's
- ✓ La Fuente Mexican Street Food
- ✓ Fritz's Railroad Restaurant
- ✓ Chip's Chocolate Factory

GROUP SEATING

- ✓ For schools and large groups visiting Monday- Friday Crown Center has an available space to sit and eat lunches
- ✓ Located on the third floor above SEA LIFE Aquarium & LEGOLAND Discovery Center (Please see below images for directions)
- ✓ Please visit Crown Center's Website for the most up to date information: <https://www.crowncenter.com/listings/lunchland>

How to get to Lunch Land

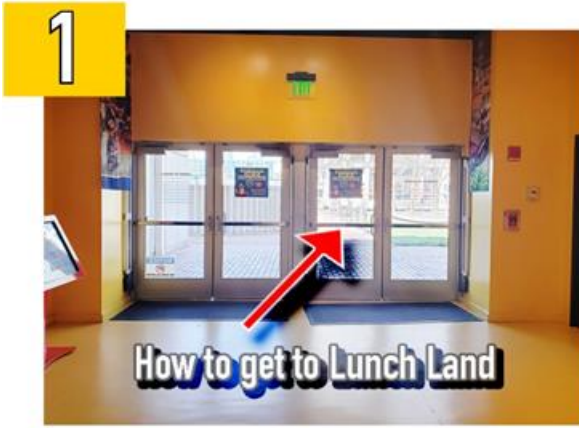

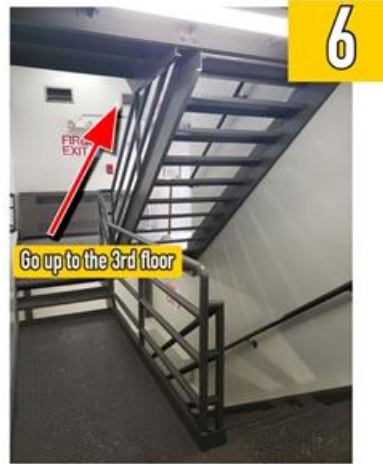

Nearby Attractions & Things to Do:

ATTRACTIONS:

- ✓ Union Station, which houses Science City, Planetarium, Model Train Gallery, City Theatre, and Exhibitions, is located one block over from LEGOLAND Discovery Center & SEA LIFE Aquarium and has tons of family fun entertainments to offer.
- ✓ The National WWI Museum and Memorial is located at Liberty Memorial is America's only museum dedicated to sharing the stories of the Great War through the eyes of those who lived it.
- ✓ The Money Museum is located at the Federal Reserve Bank of Kansas City. Guests can see how a bank processes millions of dollars in currency each day, lift a gold bar, view the historic Harry S. Truman coin collection, and partake in tons of fun interactive exhibits.
- ✓ Nelson Atkins Art Museum, located near the Country Club Plaza, is known for its encyclopedia collection of art from nearly every continent and culture.

SHOPPING

- ✓ Crown Center, located just across the street from the attraction, houses not only family friendly attractions but includes a variety of unique shopping opportunities and dining options.
- ✓ Country Club Plaza has 15 blocks of unique stores from major fashion houses to local favorites including brands like Anthropologie, Tiffany & Co, and Kendra Scott.